



GIMA

PROFESSIONAL MEDICAL PRODUCTS

LETTINO GINECOLOGIA GYNAECOLOGY BED LIT GYNÉCOLOGIQUE CAMILLA GINECOLÓGICA MARQUESA GINECOLÓGICA GYNÄKOLOGIELIEGE ΓΥΝΑΙΚΟΛΟΓΙΚΟ ΚΡΕΒΑΤΙ

**Manuale d'uso - User manual - Manuel de l'utilisateur - Guía de uso
Guia para utilização - Gebrauchs ungsanleitung - Οδηγίες χρήσης**

È necessario segnalare qualsiasi incidente grave verificatosi in relazione al dispositivo medico da noi fornito al fabbricante e all'autorità competente dello Stato membro in cui si ha sede.

All serious accidents concerning the medical device supplied by us must be reported to the manufacturer and competent authority of the member state where your registered office is located.

Il est nécessaire de signaler tout accident grave survenu et lié au dispositif médical que nous avons livré au fabricant et à l'autorité compétente de l'état membre où on a le siège social.

Es necesario informar al fabricante y a la autoridad competente del Estado miembro en el que se encuentra la sede sobre cualquier incidente grave que haya ocurrido en relación con el producto sanitario que le hemos suministrado.

É necessário notificar ao fabricante e às autoridades competentes do Estado-membro onde ele está sediado qualquer acidente grave verificado em relação ao dispositivo médico fornecido por nós.

Jeder schwere Unfall im Zusammenhang mit dem von uns gelieferten medizinischen Gerät muss unbedingt dem Hersteller und der zuständigen Behörde des Mitgliedsstaats, in dem das Gerät verwendet wird, gemeldet werden.

Σε περίπτωση που διαπιστώσετε οποιοδήποτε σοβαρό περιστατικό σε σχέση με την ιατρική συσκευή που σας παρέχουμε θα πρέπει να το αναφέρετε στον κατασκευαστή και στην αρμόδια αρχή του κράτους μέλους στο οποίο βρίσκεστε.

REF 27500 - 27501 - 27510



Gima S.p.A.
Via Marconi, 1 - 20060 Gessate (MI) Italy
gima@gimaitaly.com - export@gimaitaly.com
www.gimaitaly.com
Made in Italy



- **27501** GYNAECOLOGY BED - STANDARD
- **27510** DELUXE DELIVERY BED - with Trendelenburg

ATTENTION! The operators must carefully read and completely understand the present manual before using the product. In accord with Regulation (EU) 2017/745, this product is part of the CLASS I MEDICAL DEVICES.

DESCRIPTION

Gynecological couch made in strong structure in chrome-plated. Adjustable head and leg section. Available with Trendelenburg position with three sections with independent controls. Complete with s/s bowl \varnothing 30 cm and leg holders.

COMPONENTS

For cod. 27500 - 27501	For cod. 27510
Upper frame with padded backrest and seat	Upper frame with padded backrest and seat
Rear legs	Rear legs
Front legs	Front legs
Legrest	Legrest
Crossing tube	Crossing tube
Steel bowl with support	Steel bowl with support
Quality leg holders cod. 27500 / standard leg holders cod. 27501	Quality leg holders

ASSEMBLY MATERIAL

For cod. 27500 - 27501	For cod. 27510
N. 2 tbe 8x25	N. 2 tbe 8x25
N. 2 knobs with pin m6x20 \varnothing 30 Knobs fixed to the quality leg holders (only 27500)	N. 2 knobs with pin m6x20 \varnothing 30 Knobs fixed to the quality leg holders
N. 2 knobs with pin m8x20 \varnothing 30 For height adjustment of the leg holders	N. 4 knobs with pin m8x20 \varnothing 30 For height adjustment of the leg holders
N.2 TE 6X35 + N.2 M6 self-locking hexagon nuts For backrest and legrest	N.4 TE 6X35 + N.4 M6 self-locking hexagon nuts For backrest and legrest
N.2 TBE 8X50	N.2 TBE 8X50
N.6 washers m8x16	N.6 washers m8x16
N.1 allen key	N.1 allen key

ASSEMBLY INSTRUCTIONS

The assembly procedure of the gynecological couch and the model with trendelenburg is identical except for the assembly phase 2 relative to the seat.

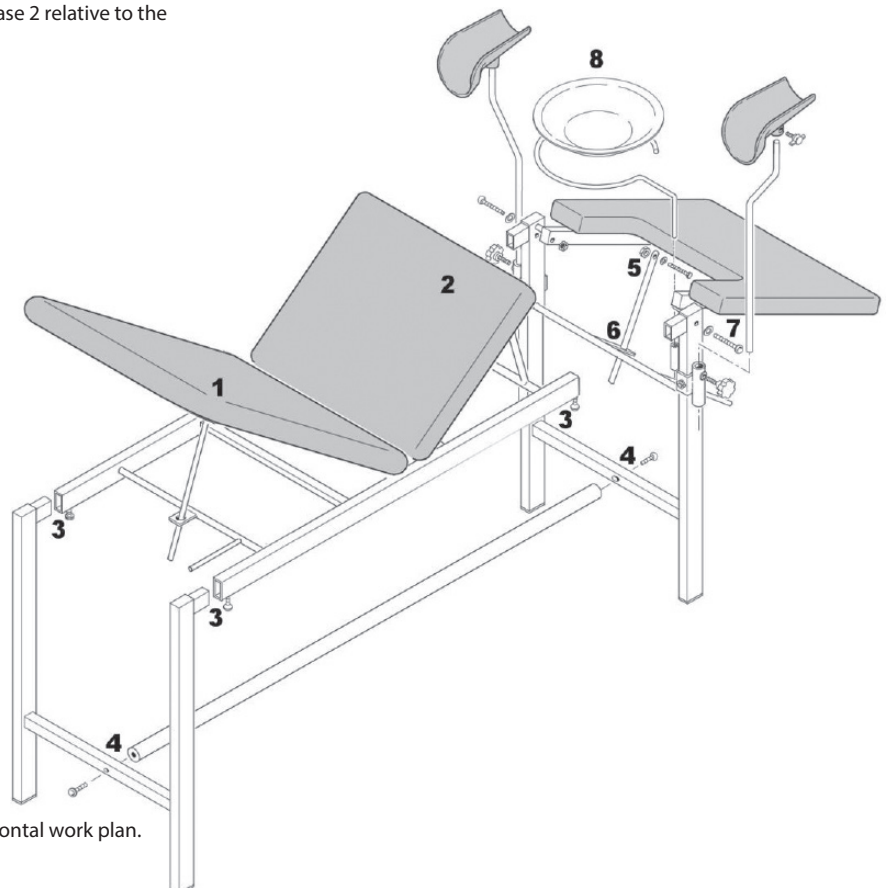

Begin the assembly phase by setting up a stable horizontal work plan.

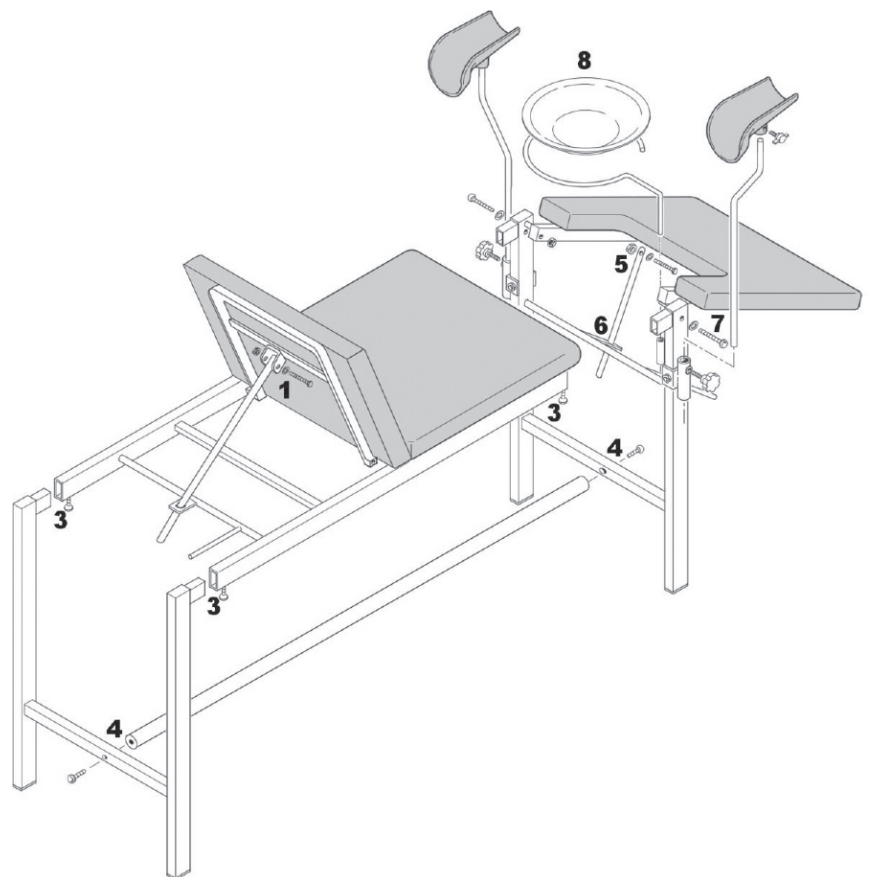

- 1) Fix the adjustment rod for backrest by **TE 6X35** screw and its hexagen nuts.
- 2) Only for Trendelenburg: fix the adjustment rod for the seat by **TE 6X35** screw and its hexagen nuts.
- 3) Unscrew the **TBE 8X16** screws fixed on the structure and screw them back by inserting the legs into the tubular frame by the allen key supplied

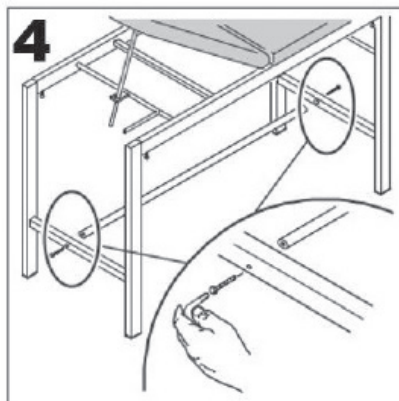
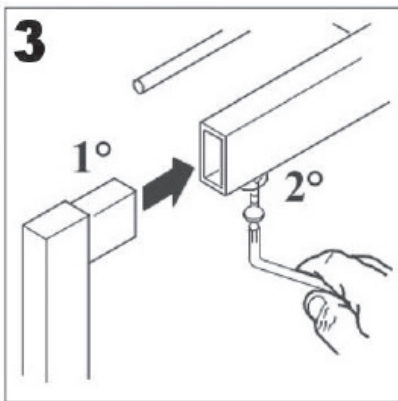

- 4) Take **TBE 8x25 screws and n.2 washers** and fix the lower crossing tube to the legs by the allen key supplied.
 - 5) Fix the adjustment rod for legrest by **TE 6X35** screw and its self-locking nut.
 - 6) Insert the leg-adjusting rod into the special perforated plate.
 - 7) Fasten the leg supports to the front legs with 2 **TBE 8X50** screws and 4 washers
 - 8) Insert the support for the bowl into the tubular welded to the leg. Take the **Steel bowl**, place it on the support.
 - 9) The **KNOBS WITH PIN M6x20 Ø30** are fixed to the quality leg holders. Unscrew them, insert leg holders into the tubular and screw knobs.
 - 10) Screw and unscrew the **KNOBS WITH PIN M8X20 Ø30** to adjust the height of the leg holders.
- NB. The standard leg holders are mounted and they only must to be fixed and adjusted by knob.**



TECHNICAL DATA

Measurement	Cm 180 x 54 x 80 h • cod. 27500/27501 H 138 cm with the backrest up completely and width 65,5 cm including knobs to fix the leg holders • cod. 27510 H 132 cm with the backrest up completely and width 65,5 cm including knobs to fix the leg holders Frame cm 100 x 53 x 47 h Trendelenburg's version: 0° - 46,5° adjustment backrest, 0° - 32° adjustment seatback Box 143 x 23 x 64 cm
Weight	30 kg (32,5 kg with box)
Max Load	110 kg

WARNINGS!

- Check the locking nuts are tightened.
- Observe the maximum flow rates indicated in the data sheets.
- Avoid direct contact with open wounds.
- Not for use in open environments.
- When adjusting the height of the couch and the back, make sure that no one inserts hands, legs or anything into the movement area: **CRUSHING RISK!**
- Move the bed without lifting it from the floor.
- Before moving the bed, unlock the castors.







MAINTENANCE AND CLEANING

- Use only original spare parts.
- Periodically check all fixing points.
- To preserve at best, it is recommended to avoid prolonged exposure to sunlight, to contact and deposit in saline and very humid environments.
- Wash the stainless steel surfaces with soapy water and use appropriate disinfectants.
- Rinse with a damp cloth and dry thoroughly.
- Do not spill on the surface cleaners containing chlorine or ammonia, fatty and oily substances.
- Do not use cleaning utensils containing iron. If necessary disinfection only use suitable non-corrosive products.

Cleaning rules for coating:

- Clean with damp soapy cloth and rinse well with clean water. Do not use solvents, bleaches, synthetic detergents, polishes or aerosol spray. Attention: Normally synthetic leather light colours should not come in contact with no fixed cloured clothes (such as jeans and similar) not to cause stains and rings that cannot be cleaned up

SYMBOLS

	Keep in a cool, dry place	REF	Product code	CE	Medical Device compliant with Regulation (EU) 2017/745
	Keep away from sunlight	LOT	Lot number		Caution: read instructions (warnings) carefully
	Consult instructions for use		Manufacturer	MD	Medical Device
	Date of manufacture	UDI	Unique device identifier		

GIMA WARRANTY TERMS

The Gima 12-month standard B2B warranty applies.