



Cod. 27950-1-2-3 Sgabelli
Cod. 27950-1-2-3 Stools

Manuale Utente
User Manual

GIMA S.p.A. – Via Marconi, 1 – 20060 Gessate (MI) – Italy
ITALIA: Tel. 02 953854.1 – Fax. 02 95381167
e-mail: gima@gimaitaly.com – www.gimaitaly.com
INTERNATIONAL: Phone +39 02 953854209 – Fax. +39 02 95380056
e-mail: export@gimaitaly.com – www.gimaitaly.com

CLASS 1 medical device, this product meets the essential provisions of the Council Directive 93/42/CEE

We advise you to carefully read this leaflet in order to understand the correct use of equipment and the basic safety requirements.

Index

- Norms
- Use
- Maintenance
- Safety instructions
- Spare parts
- Warranty
- Disposal
- Frame structure and dimensions
- How to build the product

Norms:

All models are manufactured in compliance with current UNI provisions and the 626 / 94 directive. Whether the models have wood components, these items are E1 class compliant (low emissions of formaldehyde).

All items are CLASS 1 MEDICAL DEVICES and meet the essential norms of the Council Directive 93/42/CEE

Use:

In order to adjust the height please rotate the seat base

Maintenance:

All models have to be cleaned with lukewarm water and soap and then dried. In case you would like to employ anti bacterial detergents we suggest the use of quaternary ammonium based products.

AVOID THE USE OF DENATURED ALCOHOL

For the metal parts, sturdier, you can follow the same indications.

If stool parts come in contact with corrosive chemical agents we suggest to replace damaged components.

Safety rules:

For all products; Training:

Every use beyond its intended aims is forbidden.

Promptly replace worn out or damaged parts as safety precaution.

Notice: provider is not liable for accidents due to inappropriate use of equipment.

Warning: users must know all norms included in this paragraph

Spare parts:

For all models seat, endless screw and base can be replaced

Warranty:

- This product is covered by a 24 months period since invoice date
- Manufacturer guarantees the replacement of original parts that, under normal use and maintenance, (thus excluding any professional use) are considered faulty.
- Warranty does not cover:
 - Damaged parts for typical wear and tear and incorrect use /maintenance of product.
 - Damaged parts due to bad assembly or wrong use (non compliance with this user manual rules)
- In case items are modified or components from other sources are used warranty will no longer be valid.
- Provider disclaim any civil responsibility concerning an inappropriate use of equipment and non compliance with use and maintenance norms.
- Warranty will be applied only if the request to authorized dealer will be forwarded with this leaflet appropriately stamped.
- All transportation and manpower expenses (including eventual damages or loss incurred during transportation) have to be sustained by final user. Normal maintenance or adjustment costs will also be charged to clients.
- We suggest to immediately verify after buying that product appears in good conditions and to carefully read the user manual before use.
- Every spare part request has to report article number, buy date and component number.

Disposal:

This product has to be adequately disposed by appropriate waste management companies.

Frame structure and dimensions:

Height adjustable stool through screw, AISI 304 stainless steel circular seat, thickness: 1,5 mm, diameter: 28 cm. Provided with 5 spoke base made in plastic or aluminium (diameter of 63 cm with feet). Delivered in packaged kit form.

Height 47/59 Cm.

Height adjustable stool through screw, AISI 304 stainless steel circular seat, thickness: 1,5 mm, diameter: 28 cm. Provided with 5 spoke base made in plastic or aluminium (diameter of 63 cm with swivelling castors d.50mm). Delivered in packaged kit form.

Height 51/63 Cm.

Height adjustable stool through screw, circular seat padded with washable skay, diameter: 31 cm. Provided with 5 spoke base made in plastic or aluminium (diameter of 63 cm with feet). Delivered in packaged kit form.

Height 50/62 Cm.

Height adjustable stool through screw, circular seat padded with washable skay, diameter: 31 cm. Provided with 5 spoke base made in plastic or aluminium (diameter of 63 cm with swivelling castors d.50mm). Delivered in packaged kit form.

Height 54/66 Cm.

How to assemble the product:

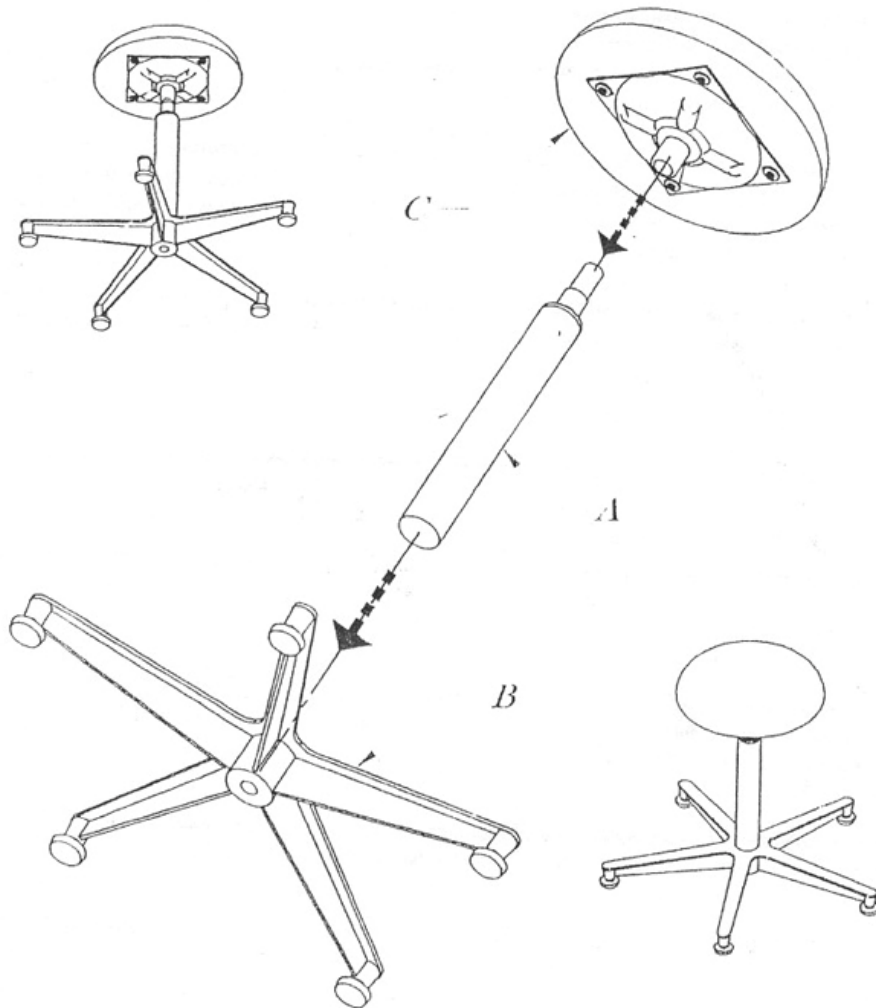

- Fix the endless screw (A) to the 5 spoke base (B).
- Fasten the seat (C) over the endless screw (A).
- Different components are put together by pressure.