

ELECTRODES

Self-adhesive electrode
for electrical stimulation

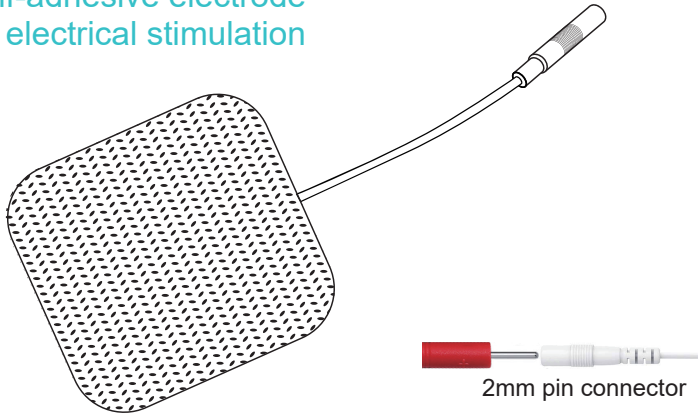

Intended use

Self-adhesive electrode is intended for use as a reusable, conductive adhesive interface between the patient's skin and the marketed electrical stimulators, i.e. TENS (Transcutaneous Electrical Nerve Stimulation), EMS (Electrical Muscular Stimulation) IF or IFC (Interferential Current) or PGF (Pulsed Galvanic Stimulation) for transmitting electrical current, for OTC (Over-The-Counter) or prescription use.



Directions for use

Application

1. Clean skin thoroughly prior to each application of electrodes. Electrodes do not stick well if any lotions, oil, make-up, dirt, etc, is left on the skin.
2. Turn the stimulator off before you apply the electrodes to your skin.
3. Insert the pins of the lead wire from the device into the electrode wire connectors.
4. Remove the electrodes from the protective liner and apply firmly to the skin.

Removal

1. Turn the stimulator off before you remove the electrodes from the skin.
2. Lifting a corner of electrode, remove the electrode from protective liner, peel it away. Do not peel the electrode by wire.
3. Place the electrodes on the liner and disconnect the lead wire by twisting and pulling at the electrode wire connectors.

Care and storage

1. Between uses, store the electrodes in the resealable bag in a cool, dry place.
2. The life of the electrodes varies depending on skin conditions, storage, amount of use, type of stimulation and stimulation site. Electrode life may be extended by carefully following the application instructions above and below.
3. Avoid electrodes from being exposed to direct sunlight or extrem humidity. Recommended storage conditions: 5°C-27°C. Relative humidity: 40%-70%
4. DO NOT leave the electrodes uncovered in air as this will decrease the viscosity and performance of the product

Caution

1. Read intructions carefully prior to use.
2. The electrodes are intended for single patient use only.
3. DO NOT apply to broken skin. Should skin rash occur, discontinue use and contact your physician. DO NOT use while driving a motorized vehicle or while operating machinery.
4. DO NOT disassemble or alter electrodes.
5. For use with electrical stimulation type devices only.
6. DO NOT use on children or infants. These electrodes have not been evaluated for pediatric use.

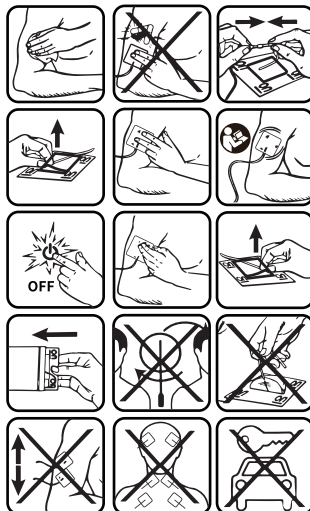

**LATEX
FREE**

EC REP

Shanghai International Holding Corp. GmbH (Europe)
Eiffestrasse 80, 20537 Hamburg, Germany



 **Shenzhen Roundwhale Technology Co., Ltd.**
202,2/F, Building 27, Dafa Industrial park, Longxi
Community, Longgang District, Shenzhen, China
Made in China



LOT