

GIMA COLPOSCOPE

• 29600 COLPY - GIMA COLPOSCOPE

Easy to use halogen colposcope mounted on a 5 wheels base.

COLPOSCOPE TECHNICAL SPECIFICATIONS

Magnifying: 6.2X with standard 10X eyepieces
 Optic system: stereo with inter-pupil adjustment and optic head at 45°
 Illumination: halogen dicroic bulb 12V - 12W
 Working distance: 26 cm
 Operating voltage: 230 V (available on request 115V)
 Norms: CLASS I Type B - IEC 601-1 CE 93/42/EEC. Made in Italy

• 29601 CAMERA CONNECTOR for 29602

To connect a camera with standard "C mount" to GIMA colposcope.

• 29602 COLPOSCOPE ANALOGIC CAMERA

Allows to connect colposcope to monitor. Need 29601.

• 29610 COLPOSCOPE SOFTWARE

• 29603 COLPOSCOPE DIGITAL CAMERA - USB

Allows to connect colposcope to PC.

CAMERA TECHNICAL SPECIFICATIONS

Camera sensor: 1/3 CCD
 Resolution: 480 lines
 Sizes: 85x53x145 mm (head 36x40x30 mm)
 Power: 230 V - 50/60 Hz

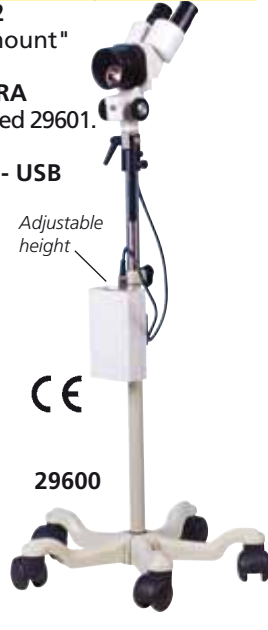

Adjustable height



29600

ALLTION LED COLPOSCOPE

• 29612 ALLTION LED COLPOSCOPE - 9X

• 29613 ALLTION LED COLPOSCOPE

3,75X, 7X, 15X - > 28,000 LUX

High quality and complete colposcopes, with excellent optics and cold, longlife white light.

Compact, lightweight and easy to use offer superior quality at a competitive price.

A special universal Teflon® ball joint gives to user 360° easy motion for gross focus.

Comes assembled, ready for use.

• 72566 PORTABLE COLPOSCOPE CAMERA

Universal. See specifications page 148

TECHNICAL SPECIFICATIONS

Magnification 9x (29612) or 3,75x, 7x, 15x (29613)
 Focus length: 316 (29612) or 300 mm (29613)
 Field of view: diameter 22 mm or 30.93/15.50/7.64
 Depth of field: > 4 mm (29612) or 18/4/2 mm (29613)
 Light intensity: > 10.000 lux (29612) or > 28.000 lux (29613)
 Interchangeable adjustable eyepiece 12.5x
 Illumination: longlife 5.9V / 5W LED
 Superior optics with individually adjustable eyepiece
 Built-in rheostat for brightness adjustment
 Easily changeable, LED bulb
 User-selectable built-in green filter
 Two (gross/fine) focus adjustment handles
 Two (gross/fine) height adjustment handles (838-1194 mm)
 Smooth action control
 Main Power: 110V/220V

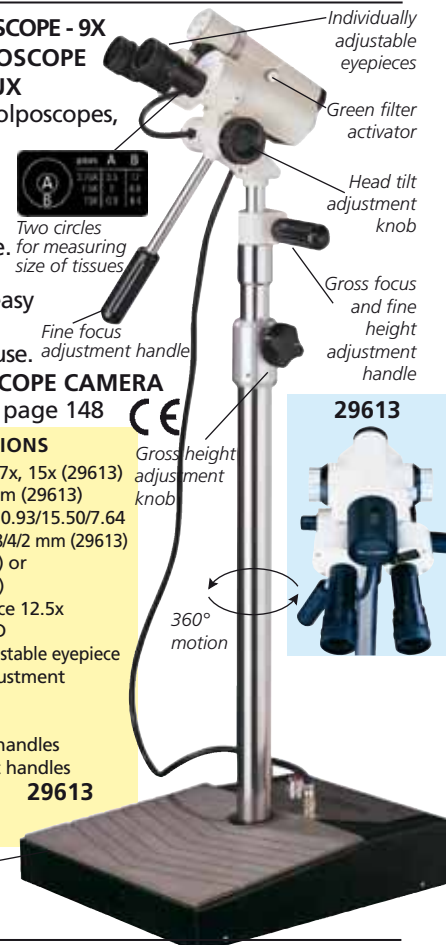

Individually adjustable eyepieces

Green filter activator

Head tilt adjustment knob

Gross focus and fine height adjustment handle



Two circles for measuring size of tissues

Fine focus adjustment handle

Gross height adjustment knob

360° motion

Roller base for easy movement



29613

29613

DIGITAL VIDEO COLPOSCOPE

• 29620 COLPRO VIDEO COLPOSCOPE

COLPRO digital video colposcope is known for its ruggedness, versatility, precision and ease of use. These devices incorporate latest digital signal processing technology to provide high resolution images for effective colposcopy diagnosis & treatment.

Wide auto focus range: Automatically focuses on the object up to 30 cm irrespective of the patient movement during procedure.

Electronic green filter: Enhances vascular discrimination without any light loss.

Continuous zoom: 1-40X zoom range allows you to examine the cervix at a desired level of magnification.

E-flip & mirror image: Powerful functions which ensure extended attention to the minutest details.

High MCD super bright shadowless light: Improves the quality of image which has 6000° K color temperature to produce natural color of tissues & vessels.

1,200,000 pixels: Responsible for unmatched & crystal clear image. It delivers excellent image quality in its class.

Magnification & real time display: Real time display of magnification & acetic acid test timer helps to see the best image at desired magnification level.

2-video output: Output can be taken on two different video monitors-computers simultaneously.

Universal connector: can be connected to any monitor with y/c or BNC video input.

• 72705 LCD MEDICAL MONITOR - 15" - flat type

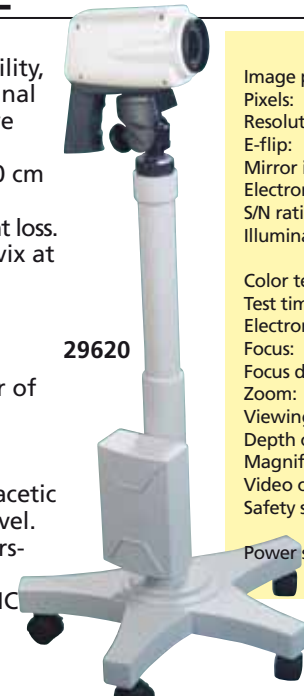

29620

TECHNICAL SPECIFICATIONS

Image processor: Sony colour CCD
 Pixels: 1,200,000
 Resolution: 825 TV Lines
 E-flip: yes
 Mirror image: yes
 Electronic Shutter: automatic
 S/N ratio: >48 db
 Illumination: high MCD super bright white shadowless LED light
 Color temperature: 7000° K
 Test timer: yes
 Electronic green filter: yes (5 steps)
 Focus: automatic or manual
 Focus distance: 20-30 cm
 Zoom: 1-45X
 Viewing area: Ø 170 mm - 10 mm
 Depth of view: Ø 200 mm - 5 mm
 Magnification display: Yes
 Video output: SD: 1x y/c, 1x BNC composite
 Safety standard: complies to IEC 60601 including EMC
 Power supply: 100-240 VAC, 50/60 Hz



1293

COLPOSCOPY IMAGE, VIDEO & PATIENT DATA MANAGEMENT SOFTWARE

• 29621 COLPOSCOPY SOFTWARE FOR COLPRO

A powerful IT tool in the hands of our busy gynaecologists to manage not only the videos, images, clinical data and details of the patients, but also to provide them an opportunity to store, edit, burn on CD or DVD, print the detailed reports and make use of graphical data for presentation. Multilanguage software (English, Spanish, Italian, German, French, Portuguese)

Compatible to Windows 7 (64-bit) / XP / Vista Operating Systems

Easy to install and maintain

Password protected log-in to ensure data privacy

Enormous level of live recording facility and image capturing at very high pixels simultaneously with just a click

Various kind of colposcopy video clippings, movies, images for reference and education purpose have been incorporated in the software

Print out of reports with relevant details can be prepared for future follow-up of the patient

Comparison mode with linked images

Forensic examination & sexual abuse

Cryo surgery report

Statistical data representation with graph

Multiformat 1-2-3-4 images diagnosis report

HAMMOND graph (biopsy graph)

Marking and highlighting



COLOUR DISPLAY, SINGLE OR TWINS FOETAL MONITORS



- 29530 SINGLE FOETAL MONITOR - FC1400
- 29531 TWINS FOETAL MONITOR - FC1400
- Superior data display**
 - 320x240 color LCD viewer (4.3 inch)
 - FHR and automatic fetal movement detection
 - 12 hours of memory capacity
 - recommended after week 30
- Extreme data accuracy and access**
 - High-accuracy and wide detection area
 - Easy on-screen scrolling function
 - Endurable watertight probes, 1 MHz
- Printout**
 - CTG analysis printing
 - Both standard and A4 size paper usable
 - Normal fax paper usable
 - High speed printout (50 cm/min)
- Other advantages**
 - Wireless central monitoring up to 8 beds (Option)
 - PC compatible
 - Internal battery lasting 2-hours (Option)
 - Power adapter 100-240 V, 50-60 Hz



COST-EFFECTIVE SINGLE FOETAL MONITOR



- 29520 FOETAL MONITOR GIMA FC 700
- Cost-effective single fetal monitor
- Extreme ultrasound doppler sensitivity**
 - High-accuracy with 1 Mhz frequency
 - Automatic/manual Foetal Movement detection
 - Auto NST (Non-stress test) function from 10 min. to 1 hour.
- Data printout**
 - CTG analysis printing
 - A4 size chart paper with perforation line
 - Plain thermal fax paper usable
 - Print speed 1, 2, 3 cm/min
- Easy-to-use**
 - One- touch operation and easy setup
 - Alarm function (FHR high-low)
 - s/w upgrade via internet

ANALYSIS FUNCTION FOR 29520, 29530, 29531	
- Period: test period	- TACHY: moderate (>160 bpm): period of that FHR is between 160~190 (minutes)
- Average baseline FHR (bpm)	- TACHY: severe (>190 bpm): period of that FHR is over 190 (minutes)
- Number of UC (frequency / h)	- BRADY: moderate (<110 bpm): period of that FHR is between 90~110 (minutes)
- Number of acceleration (frequency / h)	- BRADY: severe (<90 bpm): period of that FHR is lower than 90 (minutes)
- Number of deceleration (frequency / h)	
- Late DEC: number of late deceleration	
- Early DEC: number of early deceleration	
- Variable DEC: number of variable deceleration	

ACCESSORIES FOR FOETAL MONITORS		
For 29520	For 29530-31	
29522	29528	Paper roll - 215 mm x 23 m (29522), 152 mm x 25 m (29528)
29523	29532	Doppler transducer - spare
29524	-	UC/Toco transducer up to S/N FF07XXX
29529	-	UC/Toco transducer since S/N FF08XXX
-	29533	Toco transducer - spare
29519	29519	Trolley with 2 baskets (adjustable height)
-	29534	Battery NI-MH, 12V, 2600 mA
33747	33747	AC adaptor
29525	29525	Belt 5.3x148 cm
WIRELESS CENTRAL STATION FOR FOETAL MONITORS		
For 29520	For 29530-31	
29527	29527	Central station (PC, monitor, software, wireless, connection kit) to manage up to 8 monitor
PC CONNECTION FOR FOETAL MONITORS		
29518	29518	Software + cable for connection to PC For real time data graphic transfert to a PC with database storing (PC not included)

STANDARD ACCESSORIES (29520, 29530, 29531)
 Doppler transducer (2 for Twins Foetal Monitor)
 Toco transducer, Event maker, Gel, Printer paper, Belts, Manual

TECHNICAL SPECIFICATIONS FOETAL MONITORS (29520, 29530, 29531)

Doppler Pulsed Doppler Ultrasound frequency: 1.0 MHz Intensity: <10mW/cm ² FHR range: 50-240 bpm (± 1 bpm)	2 channels (HR, UC) (29520) 320x240 Colour LCD (29531)
Fetal movement Detection source: Ultrasound pulsed doppler	Indicators Heart rhythm with signal quality Alarm, printing on/off state AC power
UC Frequency response: DC 0.5 Hz Reference (zero) control Measurement range: 0~99 units	Set-up Alarm upper/low limit value Record speed, paper grid, Fetal Movement On/Off, Time/Date, Print contrast, Auto print period
Printer Thermal array type Print speed: 1, 2, 3 cm/min Paper feeding function	Power INPUT: AC 100-240V (50/60 Hz) 296(W)x305.5(H) x 92.5(D)mm, Approx 2.9kg (29520), 3.2kg (29530-29531)
Display 7-segment LED (29520)	External link RS-232C: Program Download



Wireless bluetooth 8 beds central system (distance 10-100 m)

GIMA FOETAL POCKET DOPPLERS - MADE IN U.K.



• **29503 GIMA FOETAL DOPPLER D2003 with display**
 Pocket foetal doppler with same specification as code 29502 but with built-in foetal heart rate processing. Foetal heart rate (FHR) is displayed on a large LCD display whilst internal signal process minimises noise artefacts.

• **29505 GIMA FOETAL DOPPLER D2005 with display and waterproof probe**

Same as code 29503 but waterproof (probe and main unit). All units are supplied in a nice bag with a tube of coupling gel and user manual in English, Spanish, French, German, Italian, Greek, Portuguese.



• **29512 ON/OFF MEMBRANE SWITCH for codes 29503, 29505**

TECHNICAL SPECIFICATION (CODES 29502 - 29503 - 29505)

Ultrasound	Frequency: 2 MHz continuous wave Transducer: 2 crystal narrow beam Output power: <10mW/mm ² SATA Audio Response 300Hz -1 KHz Fetal heart rate: multipoint real time autocorrelator (only code 29503 and 29505)
Unit Controls	Keys: 1 Key (for unit on/off) Controls: rotary volume
Indicators:	3 digit FHR LCD display (codes 29503, 29505) FHR pulse icon (codes 29503, 29505), Battery low icon
Power supply	Battery 9 V Alkaline Manganese Expected battery life: >6 hours (codes 29503, 29505) >9 hours (codes 29502)
Output	Headset: Audio output to optional headset Serial: RS232 interface (codes 29503, 29505)-jack 35 mm
Material: ABS / Noryl Size: 150 mm by 75 mm Weight: 295 g (with transducer) Classification: Class I Type B - IEC 60601-1 CE 0120 Warranty: 1 year Made in UK	

• **29502 GIMA FOETAL DOPPLER G2002**

Small, lightweight, high sensitivity pocket Doppler, with 2 MHz foetal probe, ideal for General Practitioner's or Midwife's use for routine antenatal foetal detection.

Pocket Doppler can be used to detect the beating foetal heart from about 10th week of gestation. It may be used to locate the position of the placenta, thus aiding in the early diagnosis of placenta praevia, to survey blood flow of the umbilical cord and to diagnose multiple pregnancies. Foetal signals are easily located using the lightweight narrow beam transducer while internal signal processing minimizes noise artefacts. Audio foetal heart signals are available to the user via the built-in loudspeaker or option headset, with output level controlled by rotary volume control.

• **29511 ON/OFF MEMBRANE SWITCH for code 29502**

SONOTRAX DOPPLERS

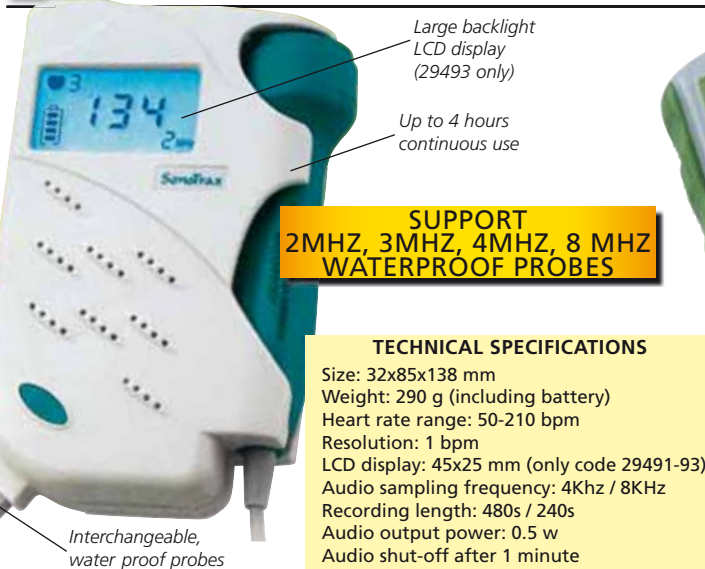

SUPPORT 2MHZ, 3MHZ, 4MHZ, 8 MHZ WATERPROOF PROBES

TECHNICAL SPECIFICATIONS

Size: 32x85x138 mm
 Weight: 290 g (including battery)
 Heart rate range: 50-210 bpm
 Resolution: 1 bpm
 LCD display: 45x25 mm (only code 29491-93)
 Audio sampling frequency: 4KHz / 8KHz
 Recording length: 480s / 240s
 Audio output power: 0.5 w
 Audio shut-off after 1 minute

BABY SOUND GIMA DOPPLER



• **29506 BABY SOUND GIMA FOETAL DOPPLER with display and interchangeable 1MHz probe**

- Portable and lightweight
- Built-in speaker to hear fetal heartbeats
- Numeric and trend curve display for FHR
- Automatic power-off function
- Backlight LCD display
- Date, time, battery status display
- Audible & visual FHR alarm
- 8-hour data storage,
- Audio-out interface
- Fetal monitor DSP technology
- High-sensitivity probe
- 1 MHz or 2/2.5 working frequency
- Store and recall FHR, up to 16 hours of FHR date storage
- Recording function

It allows hearing the heartbeat of a fetus from a built-in speaker as early as 10-12 weeks, and warns in case of serious problems of the fetus. For home and hospital use. Supplied with gel bottle, 3 AA batteries and user manual.

• **29507 2.0/2.5 MHZ DOPPLER PROBE**

• **29508 1 MHz FOETAL MONITOR PROBE**

The Fetal Doppler can be used as a portable Fetal Monitor if it works with 1MHz Fetal Monitor probe. It is suitable for long-term monitoring and will be more accurate than with the Doppler probe.

TECHNICAL SPECIFICATION

Ultrasound working frequency:	1MHz ± 5%	
Fetal heart rate:	range: 50-210 bpm resolution: 1 bpm accuracy: ± 2 bpm	
Alarm:	high limit: 160 bpm	low limit: 120 bpm
Ultrasound intensity:	< 5 mm/cm ²	
Dimension:	145x74x29 mm	
Power supply:	3 AA Batteries	Weight: 350g



GIMA code	DOPPLERS AND INTERCHANGEABLE PROBES - LATEX FREE
29490	SONOTRAX LITE DOPPLER - without probe
29491	SONOTRAX BASIC DOPPLER - with display - without probe
29493	SONOTRAX PRO II DOPPLER with backlighted display built-in audio recorder and rechargeable batteries with battery charger - without probe
29496	2MHz waterproof probe
29497	3MHz waterproof probe
29498	4MHz waterproof probe
29499	8MHz waterproof probe



PREGNANCY TESTS: MIDSTREAM AND STRIP TYPE



GIMA offers a complete line of pregnancy tests, both for OTC market (self test) and for professional use in hospital or doctor's cabinets.

All products are packed in carton boxes with multilingual user manual (English, Italian, Spanish, French, Greek, Portuguese).

Main features of pregnancy tests:

- Each test is individually packed in sealed pouch
- Very quick, some positive can be detected in 1 minute (std. 3 min)
- Early detection: it can be used since the first day you miss your period
- Reliability: 99%
- Sensibility: 25 mIU/ml
- Clinically tested

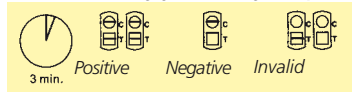

GIMA code	PREGNANCY TESTS	Type	Package
29101	SELF TEST	strip 4 mm	box of 4 pcs
29104	SELF TEST	midstream	box of 1 pc
29107	SELF TEST	midstream	box of 2 pcs
29108	PROFESSIONAL TEST	midstream	box of 25 pcs
29100	PROFESSIONAL TEST	strip 4 mm	box of 50 pcs

PERSONALIZED BOX, MANUAL AND APPROVAL CE 0197 FOR SELF TEST minimum 3000 pcs.

OVULATION - FERTILITY TESTS AND MENOPAUSE TEST



MENOPAUSE TEST:
High sensibility test for detecting FSH in urine, clinically tested. Sensitivity: 25 mIU/ml.

OVULATION - FERTILITY TEST:
Easy to use test for professional use or OTC self test market. Early detection test, 99,9% accurate and clinically tested. Sensitivity: 40 mIU/ml. All products are packed in carton boxes with multilingual user manual (English, Italian, Spanish, French, Greek, Portuguese).

- 29131 DISPLAY - English - empty
 - 29130 DISPLAY - Italian - empty
- Suitable for all "gynaecology" self tests



GIMA code	OVULATION TESTS	Type	Package
29112	SELF TEST	midstream	box of 5 pcs
29114	SELF TEST	strip 4 mm	box of 6 pcs
29115	SELF TEST	strip 4 mm	box of 12 pcs
29113	PROFESSIONAL TEST	strip 4 mm	box of 50 pcs

GIMA code	MENOPAUSE TEST	Type	Package
29109	SELF TEST	midstream	box of 2 pcs

SEE BASAL THERMOMETER FOR FERTILITY CONTROL - PAGE 45

CHLAMYDIA RAPID TEST

• **29117 CHLAMYDIA TEST - box of 20 tests**
Provide accurate results in 10 minutes, giving doctors immediate diagnosis. High sensitivity and specificity. Each box includes 20 tests, reagents, female cervical swabs, tubes, droppers, pipette and user manual.
For professional use.

Male/Female swab specimen

- Add reagent A and B to specimen
- Add 3 drops of extracted specimen
- Read results at 10 minutes

Male urine specimen

- Add reagent B and A to specimen
- Add 3 drops of extracted specimen
- Read results at 10 minutes

10 min. **Positive** **Negative** **Invalid**

CE 0197

SYPHILIS RAPID TEST

• **29118 SYPHILIS TEST - box of 40 tests**
Fast and easy to use: whole blood test protocol, results in just 10 minutes suitable for use in physician's office.
Accurate: 99.7% sensitivity & 99.6% specificity, recombinant antigens, detects IgG and IgM antibodies, treponemal antigens.
Convenient: 2 step procedure and visual interpretation.
For professional use.



VAGINITIS TEST KIT

The test includes:
1 test + vaginal swab
+ fluid specimen
(buffer solution)
in single box +
English/Italian manual

Vaginitis Test Kit

PATIENT NAME _____

• **29111 VAGINITIS TEST KIT**
A unique, easy-to-use and revolutionary test for gynecologists and operators. Finds the causes of the inflammation/vaginal infection in just 10 minutes. It replaces traditional bacterial tests that take days and costs only a tenth. When necessary dilute vaginal fluid specimen in a buffer solution and then transfer to reagent pad. The instruction manual contains a result guide and can be used to recognize: Trichomoniasis, negative gram bacteria, Gardnerella, Chlamydia, serious bacterial vaginitis. For professional use

TRICHOMONAS VAGINALIS TEST

• **29121 TRICHOMONAS TEST - box of 20 tests**
Last generation test, easy to perform, able to identify by specific antibodies the presence of trichomonas in only 10 to 20 minutes. The test has been validated by external studies and found to have a sensitivity of over 96.5% and specificity of over 95.6% when compared with reference methods for microbes identification such as BD Affirm, USA; the relative specificity is 97.3% when compared to the traditional microbiology. The vaginitis due to trichomonas vaginalis represents approx 5-10% of vaginal infections and 50% of infected woman is asymptomatic.
For professional use.



CANDIDA ALBICANS TEST

• **29105 CANDIDA TEST - box of 20 tests**
Rapid, immunochromatographic test on vaginal smear. Easy to perform, able to identify by specific antibodies the presence of Candida in only 10 to 20 minutes. The test has been validated by external studies and found to have a sensitivity of over 98% and specificity of over 94% when compared with reference methods for microbes identification (such as BD Affirm, USA). The reproducibility is at the highest level of rapid tests. As Candida affects 50% of women at least once in their life and symptoms can be mistaken for those of Bacterial Vaginosis or other Vaginitis, the use of this test together with the vaginal pH test (see code 29110) allows discriminate between the two. For professional use.
• **29106 CANDIDA SELF TEST - box of 1 test**
Same as 29105 but in single box for self testing.



BREAST SELF-EXAM PAD

• **29120 BREAST SELF-EXAM PAD - reusable**
This special pad makes breast self exam easy, more sensitive and convenient. The patented pad increases your sense of touch and the simple instructions help you perform breast self exams correctly. Clinically proved and used by physicians.
Self test.

EARLY DETECTION IS THE BEST PROTECTION



VAGINAL PH TEST

• **29110 VAGINAL PH TEST - box of 10 pcs.**
Quick test to determine vaginal PH.
An easy routine test to check vaginal PH in just 1 minute to make sure it is within the physiological limits (< 4.5). An increase in the Ph level may indicate a change in the vaginal environment. This could mean there is a possible vaginitis. The test is ideal for pregnant women and for women with particular diseases such as diabetes.
For professional use.

FemCheck pH Test

negative (yellow) | positive (blue)

PROCEDURA/PROCEDURA

- Tear open the pouch and take out the strip
- Transfer vaginal fluid specimen to the reagent pad
- Read the result in one minute

For professional use only
Lot: FeC0601
Exp: 01/2009

The kit contains:
10 cotton swabs + 10 reagent pad in an individual box with user manual (English + Italian)

CE

STREP-B TEST

• **29123 STREP-B TEST - box of 20 tests**
The new streptococcus B Ag test is a screening test for use in the detection of streptococcus B in vaginal fluid specimens. Group B streptococci (GBS) or streptococcus agalactiae are among the most frequent causes of life-threatening infectious in neonates. As standard methods require 24 to 48 hours incubation, reliable rapid tests are an utmost convenient alternative for diagnosis for the POC use. An absolute specificity and a sensitivity of 1.0x10⁵ micro-organisms characterize this special test.
For professional use.



"KARMAN" AND "BERKELEY" INTRAUTERINE SUCTION CURETTES



Length 24 cm with connector, 20,5 cm without

GIMA code	"KARMAN" STYLE CURETTES FLEXIBLE - SINGLE USE - STERILE	Minimum order
29860	Karman Curette N° 6 - 6 mm x 24 cm	box of 20
29861	Karman Curette N° 7 - 7 mm x 24 cm	box of 20
29862	Karman Curette N° 8 - 8 mm x 24 cm	box of 20
29863	Karman Curette N° 9 - 9 mm x 24 cm	box of 20
29864	Karman Curette N° 10 - 10 mm x 24 cm	box of 20
29865	Karman Curette N° 11 - 11 mm x 24 cm	box of 20
29866	Karman Curette N° 12 - 12 mm x 24 cm	box of 20



Length 20 cm with connector, 17 cm without

GIMA code	"BERKELEY" STYLE CURETTES CURVED - RIGID - SINGLE USE - STERILE	Minimum order
29870	Berkeley Curette N° 7 - Ø 7 mm x 20 cm	box of 20
29871	Berkeley Curette N° 8 - Ø 8 mm x 20 cm	box of 20
29872	Berkeley Curette N° 9 - Ø 9 mm x 20 cm	box of 20
29873	Berkeley Curette N° 10 - Ø 10 mm x 20 cm	box of 20
29874	Berkeley Curette N° 11 - Ø 11 mm x 20 cm	box of 20
29875	Berkeley Curette N° 12 - Ø 12 mm x 20 cm	box of 20



20 cm long CE 0120

• **29918 SUCTION SYRINGE - one-way self-blocking**
Special syringe with adaptor suitable for use with Karman and Berkeley currettes of any brand.
One-way self-blocking valve for safety and easier use.
Single use and sterile, 60 ml capacity. **minimum order: 10 pcs.**

AMNIOSCOPE: TUBES AND SET



To light amnioscope tubes you can use GIMA light source and Fibre Optic cables see page 127

• **29970 AMNIOSCOPE SET**
Set of three amnioscope tubes with shutter 200 mm length, 12, 16 and 20 mm diameter, and a clamp for fibre optic light.
All tubes are graduated in centimetres, have a rounded end and are sterilizable with any method.

To light amnioscope you can use GIMA 150 light source (code 30801), adapter (code 30830), F.O. cable (code 30818) and adapter for clamp (code 30840).

- 29971 AMNIOSCOPE TUBE 12 x 24 x 200 mm
- 29972 AMNIOSCOPE TUBE 16 x 24 x 200 mm
- 29973 AMNIOSCOPE TUBE 20 x 24 x 200 mm
- 29975 ANGLED CLAMP FOR LIGHT CONNECTION

SCHULTZE SALPINGOGRAPH



• **29780 SALPINGOGRAPH** CE 0124
Instrument for hystero-salpingography and tubal insufflation, Prof. Gunter K. F. Schultze from Berlin type. Made in Germany.

• **29784 HYSTERO SYRINGE**

HYSTEOSALPINGOGRAPH: STANDARD ACCESSORIES
Watch for hystero Rack-bar Hystero syringe 20 cc. Luer Lock
3 interchangeable cones (small-medium-large)

OBSTETRIC STETHOSCOPES

- 32501 SHORT OBSTETRIC STETHOSCOPE - beech-wood
 - 32502 LONG OBSTETRIC STETHOSCOPE - beech-wood
- These stethoscopes are hand-craft manufactured, made in beech-wood accurately selected and seasoned for at least 3 years. They have a perfect finish with a special transparent varnish. Packed in single box. Made in Germany.
- 32505 PINARD STETHOSCOPE - aluminium



32505 32501 length 13 cm 32502 length 17 cm

LATEX PROBE COVERS

- 29513 LATEX PROBE COVERS - transparent - box of 50
 - 29514 LATEX PROBE COVERS - transparent - box of 500
- For ecography and doppler probes. Length 17 cm, Ø 3.3cm
Individually packed in single plastic bag.



29513 CE 0318

CUPS FOR HYSTEROGRAPHY AND SIFT SCREW SYRINGE

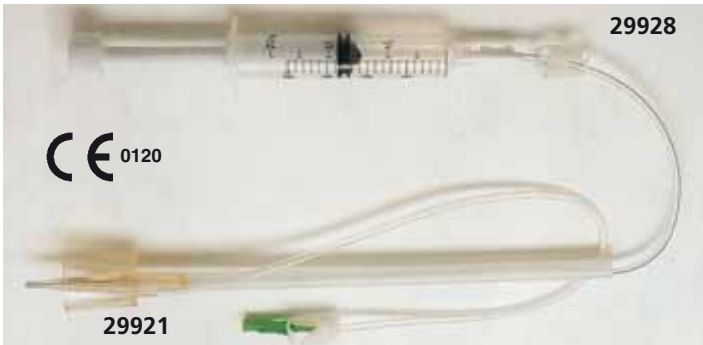

GIMA code	CUPS FOR HYSTEROGRAPHY DISPOSABLE - STERILE	Minimum order
29920	Cups 25 mm	10 pcs.
29921	Cups 30 mm	10 pcs.
29922	Cups 35 mm	10 pcs.
29923	Cups connector - sterile	10 pcs.
29928	SIFT syringe for cups	10 pcs.

CUPS FOR HYSTEROGRAPHY - Latex free

The device consists of a rigid, transparent tapered cup with a central conical cannula; it is equipped with a 25 cm long flexible, pliable manipulator joined to the cup and two tubes equipped with clamps. One of these provides the vacuum, while the other injects the radiopaque medium. Perfect adhesion to the cervix by self-centering is ensured by the tapered shape of the cup and the progressive application of a vacuum to the cup.

The suction cup/cannula unit is radiotransparent and allows the proximal area of the endocervix to be controlled. The radiologist is able to manipulate at a distance from the radioactive field while at the same time comfortably immobilizing the uterus.

SIFT SCREWTHREAD SYRINGE

Contrast medium is injected by turning the position of the syringe which is equipped with a thread, to enable easy and regular injection of the contrast medium.

If cup is used on our sift syringe, connector is not needed.

AMNIOCENTESIS NEEDLES

For transabdominal sampling of amniotic fluid for prenatal diagnosis of genetic disorders of the foetus. It is also used for cytogenetic and biochemical studies. Accurate sharpening of the needle allows an easy and atraumatic insertion. Its mandrel is provided with an ultrasound detectable tip allowing an echo-guided insertion, and it is colour coded for an easy identification of the needle size. The needle is provided with an adjustable stopper to determine insertion depth, and with a female luer lock connector to collect the amniotic fluid through a syringe. Made in Italy.



GIMA code	AMNIOCENTESIS NEEDLES - STERILE
29630	Needle 20 G x 100 mm
29631	Needle 20 G x 120 mm
29632	Needle 20 G x 150 mm
29633	Needle 20 G x 180 mm
29634	Needle 21 G x 120 mm

RUBBER PESSARY



Individually packed in carton box with English user manual

GIMA code	PESSARY FOR UTERINE PROLAPSE
29963	Rubber Pessary Ø 60 mm
29964	Rubber Pessary Ø 65 mm
29965	Rubber Pessary Ø 70 mm
29966	Rubber Pessary Ø 75 mm
29967	Rubber Pessary Ø 80 mm
29968	Rubber Pessary Ø 85 mm
29969	Rubber Pessary Ø 90 mm

UMBILICAL CLAMP



• 29943 X-SAFE UMBILICAL CORD CLAMP - sterile

Disposable large size umbilical cord clamp to allow a proper clamping of all umbilical cords and prevent their outcoming from the closing comb. Individually packed in coupled cellophane (nylon/poliethilene) and medical paper to ensure safe hygienic conditions to user. Sterilized by ethylene oxide. Made in Italy.

Minimum order: 600 pcs.

MEMBRANE PERFORATOR



• 29945 AMNIOTIC MEMBRANE PERFORATOR-sterile

Disposable amniotic perforator. This system is thought to be completely safe to avoid lesions to the foetus. Supplied in single sterile envelope.

I.D. BRACELET

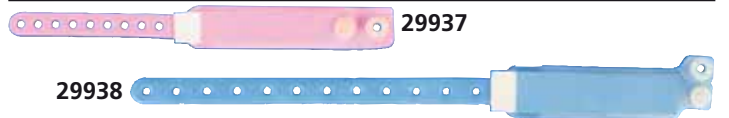

GIMA code	I.D. BRACELET	Colour	Minimum order
29936	Newborn	light blue	box of 100 pcs.
29937	Newborn	pink	box of 100 pcs.
29938	Mother	light blue	box of 100 pcs.
29939	Mother	pink	box of 100 pcs.

SUCTION CUPS

• 29980 SILICONE SUCTION CUP Ø 60x210 mm

• 29981 SILICONE SUCTION CUP Ø 70x210 mm

Made in medical grade silicone

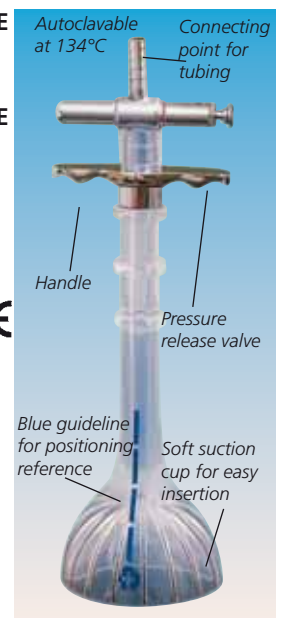

AYRE SPATULA - BIRCH WOOD

A 29743
29745

B 29744

GIMA code	AYRE SPATULA - WOOD	Length	Minimum order
29743	Ayre Spatula A <i>5 box of 100 pcs = of 500 pcs</i>	18 cm	500 pcs.
29744	Ayre Spatula B <i>5 box of 100 pcs = of 500 pcs</i>	18 cm	500 pcs.
29745	Sterile Ayre Spatula A <i>Individually packed in sterile pouch, in box of 100</i>	18 cm	100 pcs.

AYRE SPATULA - PLASTIC

29746

29749

29746

Used for ecto-cervical and posterior fornix cells sampler in uterus neck cancer screening procedures.

GIMA code	AYRE SPATULA - PLASTIC	Material	Length	Minimum order
29746	Ayre Spatula <i>Packed in plastic bags of 25 pcs., in carton of 400 pcs.</i>	PP	22 cm	400 pcs.
29748	Sterile Ayre Spatula A <i>Individually packed in sterile pouch, in box of 100</i>	PP	18.8 cm	100 pcs.
29749	Sterile Ayre Spatula B <i>Individually packed in sterile pouch, in box of 100</i>	PP	18.8 cm	100 pcs.

GIMA BRUSH - MADE IN ITALY

29742

sterile pack

brush Ø=6 mm

20 cm

CE 0123

CE 29739-29740

- 29739 GIMA BRUSH - conical - bag of 25 pcs.
 - 29740 GIMA BRUSH - conical - box of 400 pcs.
- These single-use endocervical brushes are an efficient method of collecting vulval, endocervical and nasal surface samples for cytological/microbiological examinations. Non sterile. Packed in plastic bags of 25 units, in carton of 400 units.
- 29742 GIMA BRUSH - conical - STERILE - box of 500 pcs
- As code 29740, individually packed in sterile plastic bag. Both codes are made in Italy.

GIMA BRUSH - STERILE

CE 0476

29736

Special "ball" to avoid cervix puncture and patient pain during the procedure

29735

20 cm

Each brush is packed in a single sterile pouch and box of 100 pouches

- 29735 GIMA BRUSH B - sterile - box of 100 pcs.
 - 29736 GIMA BRUSH BALL - sterile - box of 100 pcs.
- Each brush is packed in a single sterile pouch and box of 100 pouches.

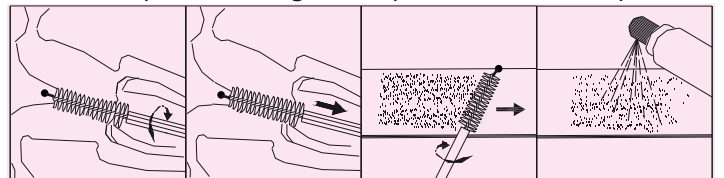

COTTON SWABS

29753

STERILE SWAB STICK

29754

29755

29756

GIMA code	COTTON SWABS	Shaft Material	Cotton Ø	Shaft length	Minimum order
29750	Cotton Swab <i>Packed in plastic bags of 25 pcs., in carton of 400 pcs.</i>	Plastic	1 cm	20 cm	400 pcs.
29753	Sterile Cotton Swab <i>Packed in box of 100 pcs.</i>	Plastic	0.5 cm	15 cm	100 pcs.
29754	Cotton Swab <i>Packed in plastic bags of 100 pcs., in carton of 1000 pcs.</i>	Wood	0.5 cm	15 cm	1,000 pcs.
29756	Cotton Swab <i>Packed in plastic bags of 50 pcs., in carton of 500 pcs.</i>	Wood	1 cm	15 cm	500 pcs.

WALLACH PAPETTE, GIMA COLLECTOR

WALACH

29737

29738

CE

29738

29737

With Wallach papette all it takes is a simple rotating motion to collect a total sampling endocervical and ectocervical cells, including the transformation area, with less trauma.

GIMA code	PAPETTES	Material	Shaft length	Minimum order
29738	Wallach papette <i>Each papette is packed in a single sterile pouch and box of 100 pouches</i>	Plastic	16 cm	100 pcs.
29737	Sterile GIMA collector <i>Packed in bags of 100 pcs.</i>	Plastic	17 cm	100 pcs.

CERVIX BRUSH PLUSH - CERVICAL SPOON



• 29758 CERVICAL SPOON - sterile - box of 100 pcs.

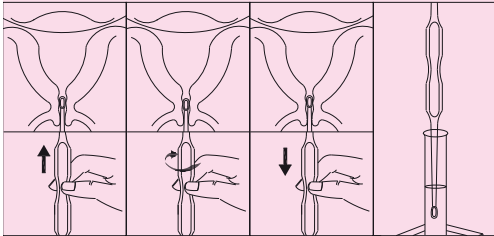

CE 0476

• 29759 CERVICAL BRUSH PLUSH - sterile - box of 100 pcs. With sleeve and retractile at rhombic part

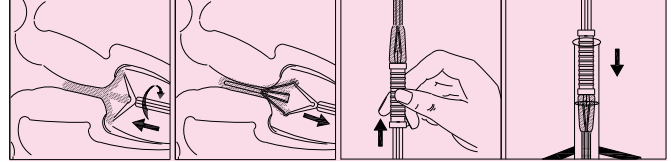

CANNULAS FOR ENDOMETRIAL SAMPLING

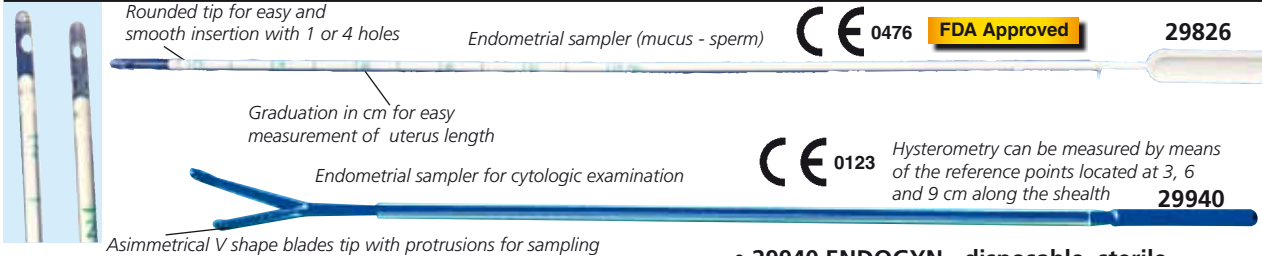

Rounded tip for easy and smooth insertion with 1 or 4 holes

Endometrial sampler (mucus - sperm)

CE 0476

FDA Approved

29826

Graduation in cm for easy measurement of uterus length

Endometrial sampler for cytologic examination

CE 0123

Hysterometry can be measured by means of the reference points located at 3, 6 and 9 cm along the sheath

29940

Asymmetrical V shape blades tip with protrusions for sampling

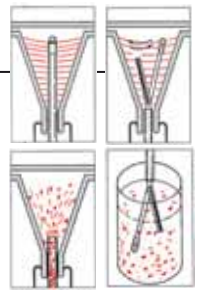

29940

• 29826 PIPELLA 1 hole - disposable, sterile

• 29827 PIPELLA 4 holes - disposable, sterile

For endometrial cytologic sampling and sperm sampling in post-coital tests.

It allows a painless and easy routine screening of the endometrium avoiding dilation and traction of the uterus neck. External Ø 2 ±0.5 mm - length 27.5 cm Single use, sterile.

minimum order: 100 pcs.

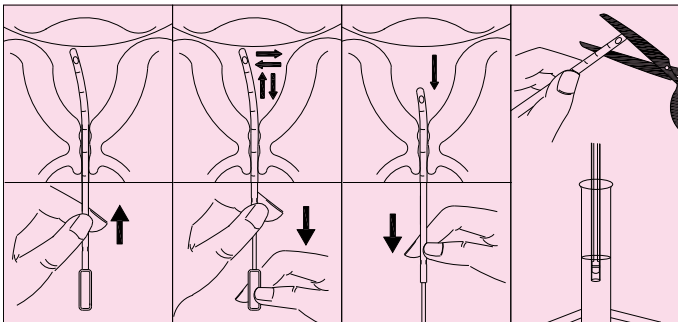

• 29940 ENDO GYN - disposable, sterile

For cytologic endometrial sampling. It allows a painless and easy routine screening of the endometrium avoiding dilation and traction of the uterus neck. An outer sheath covers a mandrel with asymmetrical "V" shaped blades on the top. External Ø 3.0 mm - Length 20 cm. Each arm features fine toothings and thin cutting edges which are able to remove and keep more endometrial tissue. The head of one of the two arms features a hemispherical head which, when it goes back inside the sheath, allows for previously removed tissue to be aspirated

minimum order: 25 pcs.

HYSTEROMETER

HYSTEROMETER with slider - single use - sterile
Calibrated reading on the handle, flexible

CE 0120

29930-32		
GIMA code	HYSTEROMETER SINGLE USE - STERILE - LATEX FREE	Minimum order
29930	Hysterometer CH 10	25 pcs.
29931	Hysterometer CH 12	25 pcs.



SPRAY FOR CITOTOLOGY FIXATION AND SLIDES



29775

29777

29775

29774

GIMA code	MICROSCOPE SLIDES Size 76x26 mm, 1.0-1.2 thick 45° corners minimum order: pack of 200 pcs. (4 boxes of 50 pcs.)
29774	Plain side, ground edges
29775	Single end frosted, sandblasted band, ground edges
29777	Twin frosted in both ends, ground edges, sandblasted band



29776

• 29776 BOX FOR SLIDES
Plastic, transparent box for storage of up to three slides.

• 29778 GIMAFIX SPRAY FOR CITOTOLOGY FIXATION
Fixer for cytology. Composition: isopropanole, polyethylenglycole. It does not contain propellants deleterious for the ozone. 250 cc bottle.

minimum order: 12 bottles



29778

DISPOSABLE STERILE VAGINAL SPECULUM



SIDE SCREW SPECULUM - with gradual adjustment - sterile
Disposable sterile speculum with gradual screw-action adjustment. Available in 3 sizes. Made in China.

GIMA code	SIDE SCREW VAGINAL SPECULUM - STERILE	Minimum order
29983	SIDE SCREW speculum - small Ø 20 mm	box of 100
29984	SIDE SCREW speculum - medium Ø 28 mm	box of 100
29985	SIDE SCREW speculum - large Ø 33 mm	box of 100
29986	SIDE SCREW speculum - mixed* sizes	box of 100

*mixed box includes 20 small, 70 medium, 10 large vaginal speculum



CENTRAL PIN, MIDDLE SCREW, TACHE SPECULUM
Three different models of disposable sterile speculum. Sold in mixed box containing 3 sizes: small, medium, large. Made in China.

GIMA code	CENTRAL PIN / MIDDLE SCREW / TACHE STERILE	Minimum order
29991	CENTRAL PIN Speculum - mixed* sizes	box of 100
29995	MIDDLE SCREW Speculum - mixed* sizes	box of 100
29987	TACHE Speculum - mixed* sizes	box of 100

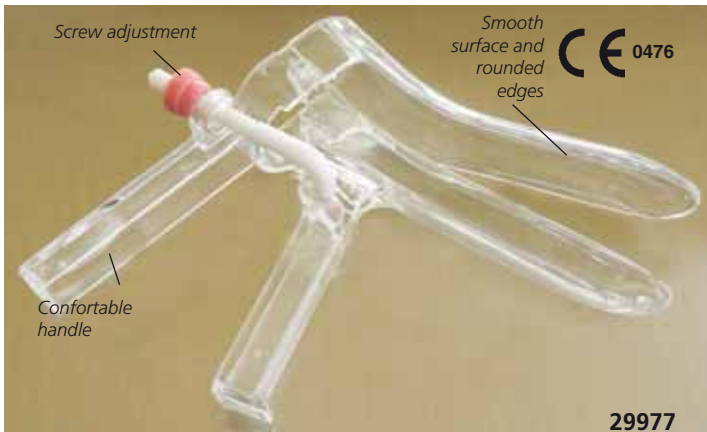

CUSCO SPECULUM - with gradual adjustment - sterile
Disposable speculum with gradual screw-action adjustment. It is manufactured with the best non-toxic transparent material, comes in a single transparent vacuum pack and is sterilized with ethylene oxide. Sterilization is guaranteed by the special quality control label on each pack. Available 3 sizes distinguishable through screw color. Made in Europe.

GIMA code	CUSCO VAGINAL SPECULUM - STERILE	Minimum order
29976	CUSCO Speculum - small 85 x 20 mm	box of 120
29977	CUSCO Speculum - medium 90 x 28 mm	box of 120
29978	CUSCO Speculum - large 100 x 36 mm	box of 108

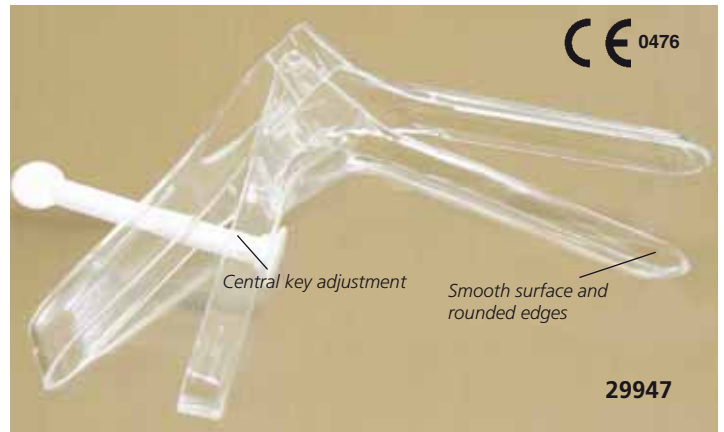

PERNO SPECULUM - with central key adjustment
For dilation of the vaginal canal to expose the uterus neck. It allows the adjustment of the vaginal opening by positioning the blades and locking the central key. The smooth surface and rounded edges aid a comfortable introduction. The central key can be bent down for an easier introduction of cumbersome instruments 3 sizes distinguishable through key colour. Made in Europe.

GIMA code	PERNO VAGINAL SPECULUM - STERILE	Minimum order
29946	PERNO Speculum - small Ø 20 mm	box of 120
29947	PERNO Speculum - medium Ø 26 mm	box of 120
29948	PERNO Speculum - large Ø 30 mm	box of 120

STAINLESS STEEL VAGINAL SPECULUM - CUSCO AND COLLIN



GIMA code	STAINLESS STEEL SPECULUM
29770	Cusco stainless steel speculum - small 100 x 30 mm
29771	Cusco stainless steel speculum - medium 110 x 34 mm
29772	Cusco stainless steel speculum - large 125 x 36 mm
29773	Cusco stainless steel speculum - virgin 110 x 17 mm
29763	HF Cusco stainless steel speculum - medium with insulation for HF applications
29768	Collin stainless steel speculum - medium

All speculum are individually packed in carton box

STERILE PAP TEST KITS

CE 0373

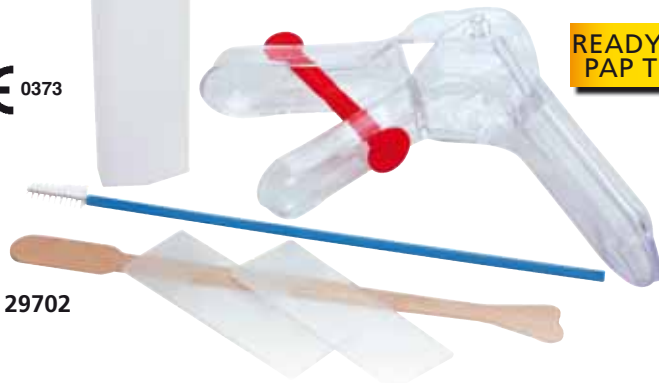

29702

READY TO USE
PAP TEST KIT

- **29702 PAP TEST KIT - sterile - box of 100 pcs.** Pap-Test is a painless examination to detect the presence of any anomalous cells on the cervix. It allows an early diagnosis of uterus neck cancer. The functional configuration of the kit allows a ready to go operation. The kit includes: one latex glove, one perno speculum (medium size), one brush, one Ayre spatula (wooden), two slides and one box for them. Individually packed in sterile pouch.

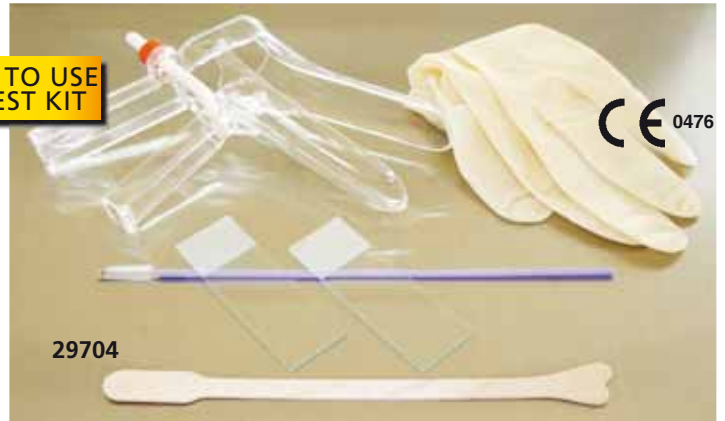

29704

CE 0476

- **29704 PAP TEST KIT - sterile - box of 50 pcs** The kit includes: one latex glove, one side-screw speculum (medium size), one GIMA brush ball, one Ayre spatula A size (wooden), two slides. Individually packed in sterile pouch.

- **29703 PAP TEST KIT - sterile - box of 100 pcs** Same as 29702 but without speculum



29703

LUBRIGIMA: LUBRIFICANT GEL

- **29960 LUBRIGIMA - 250 ml** For an easy insertion of instruments during gyn. examinations. Its special composition and high transparency does not alter the visual image when optical instruments are used. It does not contain spermicides, it does not grease or stain. It has an acid Ph and a good electrical conductivity. It is soluble in water. The gel is well absorbed by the skin and does not cause irritations to the mucosa. LATEX FREE. Made in Italy.

minimum order: 6 pieces



29960

LUBRICATING GEL

- **29957 LUBRICATING GEL** sachet 5 g - box of 100
- **29959 LUBRICATING GEL** tube 82 g - 1 tube Hypoallergenic lubricating gel, does not irritate skin, dissolves in water and is easily cleaned.



29957



29959

GYNOLIGHT



29962

Supplied in a soft bag with two 1.5 V battery

- **29962 GYNOLIGHT** It allows illumination of the vaginal canal. It fits both central key and side-screw specula. It is provided with two points light source for a proper illumination of the vaginal canal, and its upper point light source can be adjusted by the operator. It's easy to set and remove thanks to spring side-holders. Gynolight does not come into contact with mucosa. Cold sterilization. Made in Italy.

PROCTOSCOPES

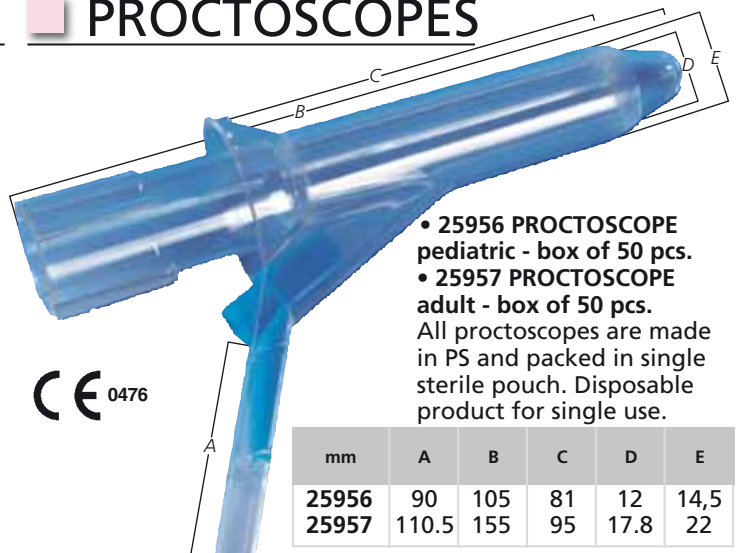

CE 0476

- **25956 PROCTOSCOPE** pediatric - box of 50 pcs.
- **25957 PROCTOSCOPE** adult - box of 50 pcs. All proctoscopes are made in PS and packed in single sterile pouch. Disposable product for single use.

mm	A	B	C	D	E
25956	90	105	81	12	14,5
25957	110.5	155	95	17.8	22

DISPOSABLE RECTOSCOPE, PROCTOSCOPE, ANOSCOPE

25953 F.O. ILLUMINATION HEAD

This head perfectly fits and illuminates the disposable anoscopes, rectoscopes, proctoscopes for GIMA, HEINE, WELCH ALLYN, GPS. It can be connected to a light source by a F.O. cable or to a LED illumination system. See at page 127.

25947 DISPOSABLE ANOSCOPE - sterilized - box of 60

Length 10 cm, with stylet diameter of 17 mm, suitable for treatment of haemorrhoids.

25948 DISPOSABLE PROCTOSCOPE - sterilized - box of 50

Length 13 cm, with stylet diameter of 17 mm

25949 DISPOSABLE RECTOSCOPE - sterilized - box of 50

Length 25 cm, with stylet diameter of 17 mm, scale in cm, illumination in distal exit thanks to the opaque black tube placed inside the transparent body which enables the light to shine without shadow.

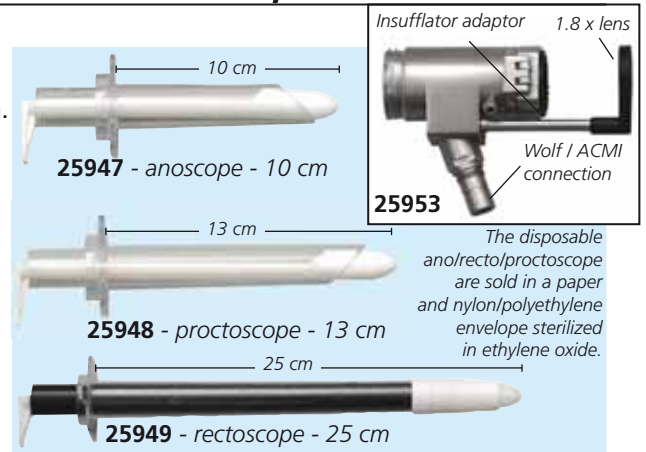

The disposable ano/recto/proctoscope are sold in a paper and nylon/polyethylene envelope sterilized in ethylene oxide.

LIGHTING SYSTEMS: LIGHT SOURCE OR ILLUMINATED HANDLE

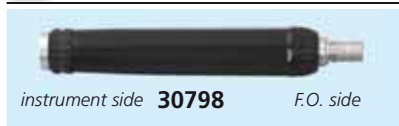

LIGHTING SYSTEMS

All products in this page are supplied with Acmi/Wolf light connection. To bring the light to these connection it is necessary to buy a Wolf adaptor (30841) a F.O. cable (30818-30826) a light source adaptor (30830) and a light source (30801-30802). See page 127.

To better hang the instruments during the use we suggest below handle that can be placed between the instrument and F.O. cable.



• **30798 HANDLE** for Ano/Procto/Rectoscope and Sigmoidoscopes. Need light source
Alternatively you can choose a more economic solution, for illumination, inclusive of handle

• 30799 ILLUMINATED HANDLE 6.0 VOLT - HALOGEN BULB

Works as an independent light source for F.O. instruments. Direct connection to all F.O. instruments in this page.

F.O. ANOSCOPES, PROCTOSCOPES

F.O. ANOSCOPES



F.O. PROCTOSCOPE



F.O. SIGMOIDOSCOPIES



GIMA code	F.O. ANOSCOPES* - PROCTOSCOPES*
29400	F.O. Anoscope Ø15x70 mm - with obturator - wolf/Acme connector
29401	F.O. Anoscope Ø20x70 mm - with obturator - wolf/Acme
29402	F.O. Anoscope Ø25x70 mm - with obturator - wolf/Acme
29403	Set of 3 F.O. anoscopes with Wolf and Storz connector in a case
29405	F.O. Proctoscope Ø20x130 mm - with obturator with 2.0x
30844	Storz adaptor (to connect F.O. ano/procto to Storz cable) - spare
30840	ENDO STORZ ADAPTOR - to connect with F.O. cable

*Include STORZ adaptor (30844)

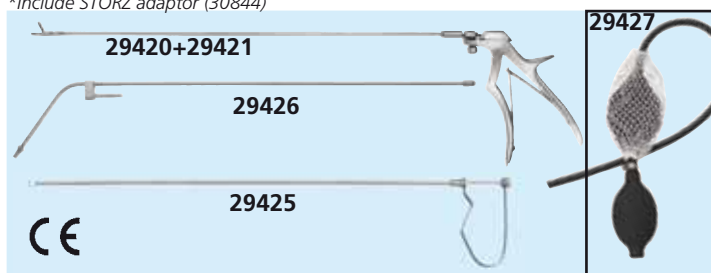

GIMA code	S/S ACCESSORIES FOR F.O. ANOSCOPES, PROCTOSCOPES, SIGMOIDOSCOPIES
29420	Handle for Biopsy forceps
29421	Biopsy forceps 3.5x8 mm Cup Jaws - 420 mm
29422	Biopsy forceps 4 mm - Cutting Jaws - 420 mm
29425	Sponge Holding forceps - 400 mm
29426	Suction Tube - 400 mm
29427	Twin Bellow Insufflator

GIMA code	F.O. SIGMOIDOSCOPIES WITH 2.0 X MAGNIFICATION SWIVEL LENS
29410	F.O. Sigmoidoscope - 12x200 mm with Wolf/Acme adaptor
29411	F.O. Sigmoidoscope - 16x250 mm with Wolf/Acme adaptor
29412	F.O. Sigmoidoscope - 21x200 mm with Wolf/Acme adaptor
29413	F.O. Sigmoidoscope - 21x250 mm with Wolf/Acme adaptor
29414	F.O. Sigmoidoscope - 21x300 mm with Wolf/Acme adaptor
30844	Storz adaptor (to connect sigmoidoscope to Storz cable)
30840	ENDO STORZ ADAPTOR - to connect with F.O. cable

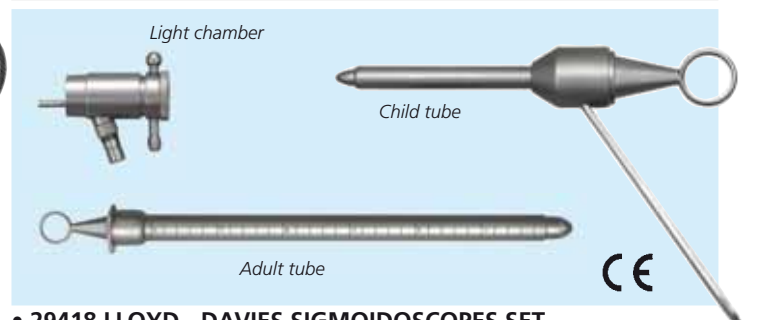

• 29418 LLOYD - DAVIES SIGMOIDOSCOPIES SET

Sigmoidoscope set is composed by one light chamber, with Acme/Wolf adaptor, one adult tube Ø 20 x 300 mm, one boy tube Ø 16 x 250 mm, and one child tube Ø 10 x 75 mm, in a soft pouch.

To light set you can use illuminated handle (code 30799) or Gima light source (30801), light source adapter (30830), F.O. cable (30818) and adapter (30841).